

District 4 Park Facilities Focus

DISTRICT

4

Lion Park	1927	4.38 Acres
Lions Indoor Pool	1972	
Raymond Park	1954	2.17 Acres
Larson Park	1937	4.4 Acres
Tieton Terrace Park	1939	0.40 Acres
Naches Parkway	1913	0.47 Miles
Roselma Garden Club Park	1975	0.45 Acres
Portia Park	1924	0.52 Acres
South 6 th Avenue Parkway	1969	0.17 Acres



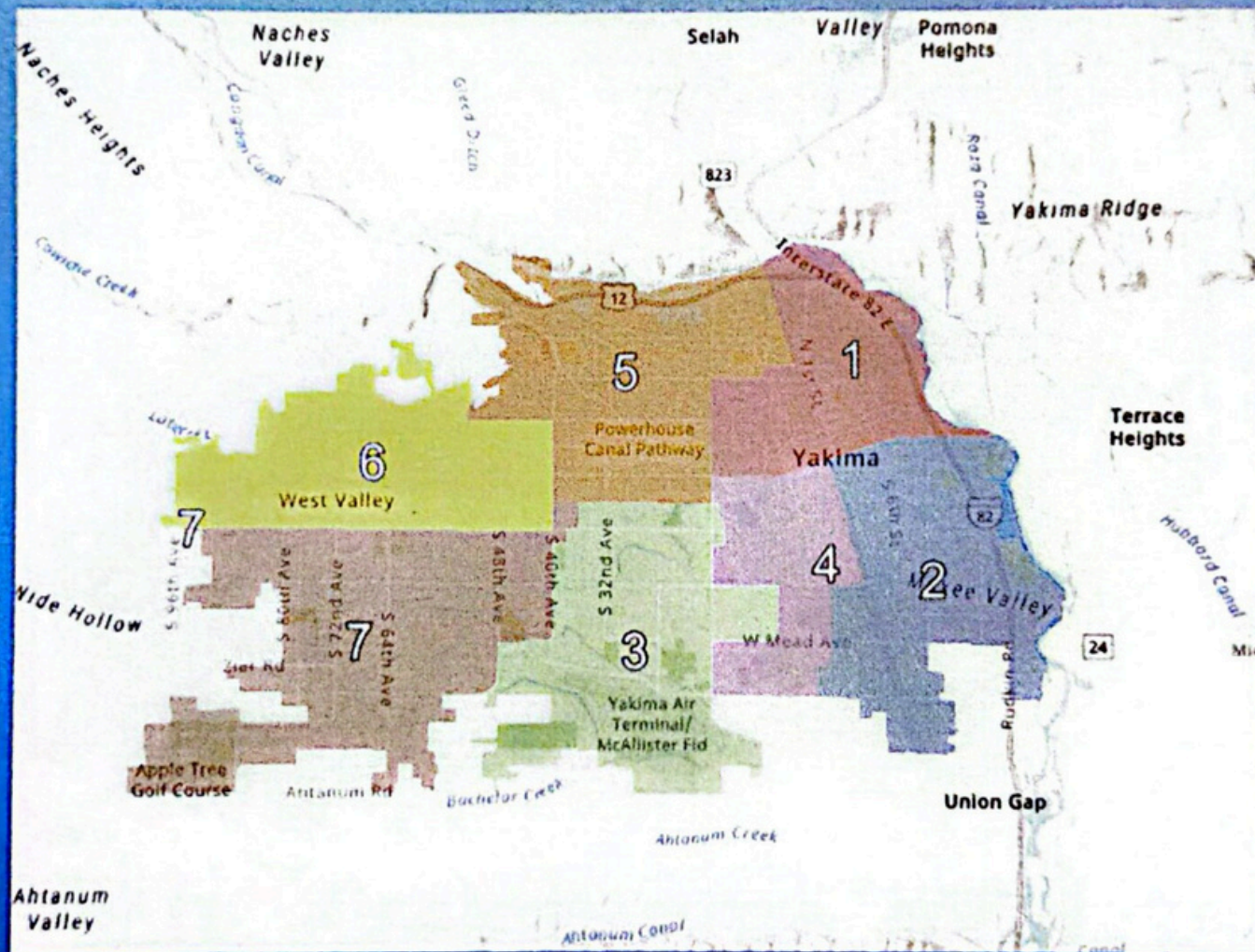



LIONS PARK & INDOOR POOL – 4.38 Acres

Lions Park and Indoor Pool is located west of the downtown on South 5th Avenue and Pine and is the site of the only City operated indoor swimming pool. The 25 yard pool is used year-round for a variety of aquatic programs; including school district swim activities, and senior use. The park provides playground equipment and tennis courts. The Yakima School District renovated the parking lot and tennis courts during the renovation of Davis High School.

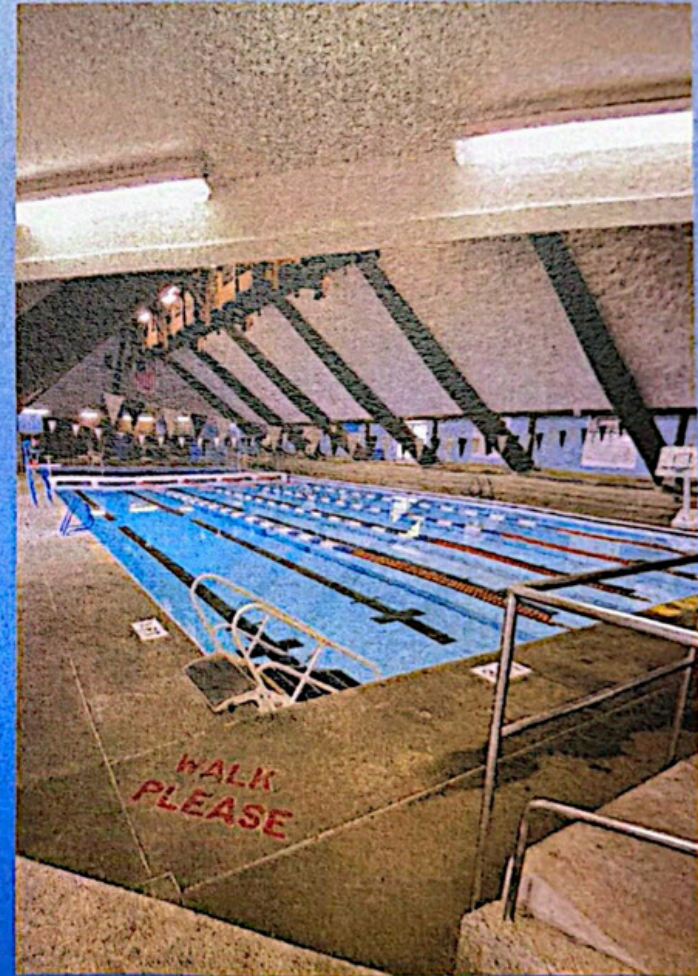



Maintenance /Operation Expense: \$458,000

Revenue: \$166,000

Capital Improvements:

2002 - 2003 \$6,000 Improvements – City

2003 - \$5,000 Aquatic Lift – City

2007 - \$233,000 Update – City

2014 - \$6,000 Lockers – City

2014 - \$75,000 Pool Electrical Upgrade – City

2015 - \$20,000 Pool Facility Audit – City

2015 - \$285,000 Tennis Court & Parking Lot Renovation – YSD

2016 - \$16,000 Climbing Wall (pool) – City

2016 - \$47,000 Engineering Design for New Filtration System – City

2018 - \$35,000 Master Plan – City

2019 - \$85,000 Playground – Lions Club & City

Total Capital Improvements: \$813,000

Planned Capital Improvements:

- New Sign
- New Filtration System for Pool
- New Dehumidifier for Pool
- Replace Bulkhead for Pool
- Picnic Shelter
- New Windows and Doors for Pool Building
- Remodel Pool Building Restroom / Locker Rooms
- Remodel Front Entrance Reception Area
- Irrigation Improvements / Upgrade
- Outdoor Lighting Addition
- Enclose Patio Area with Fence





RAYMOND PARK – 2.35 Acres

Raymond Park is located at South 1st and Arlington Avenues with residential neighborhoods to the west and an industrial area to the east. The park is mostly a passive park with picnic tables, trees and open space. An aged playground was removed. It is anticipated that a new playground will be constructed when funds allow.

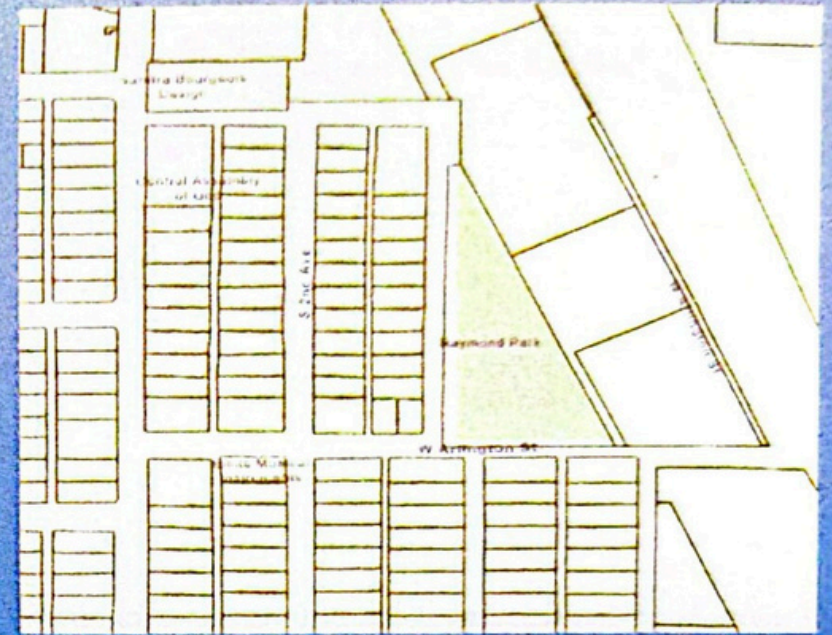

Maintenance/Operation Expense: \$14,000

Revenue: NA

Capital Improvements: NA

Planned Capital Improvements:

- New Sign
- Playground
- Picnic Shelter



LARSON PARK – 4.4 Acres

Larson Park is located adjacent to Yakima Valley Community College. The primary users are from the immediate neighborhood and the college. Amenities include a picnic shelter, swings, restroom/storage building and asphalt pathway.



Maintenance/Operation Expense: \$32,000

Revenue: \$900

Capital Improvements:

2003 - \$129,000 Restroom – City of Yakima

2016 - \$12,000 Resurfaced Walkway – Donation, City of Yakima

Total Capital Improvements: \$141,000

Planned Capital Improvements:

- New Sign
- Playground / Remove Swings
- New Picnic Shelter
- Add / Upgrade Lighting

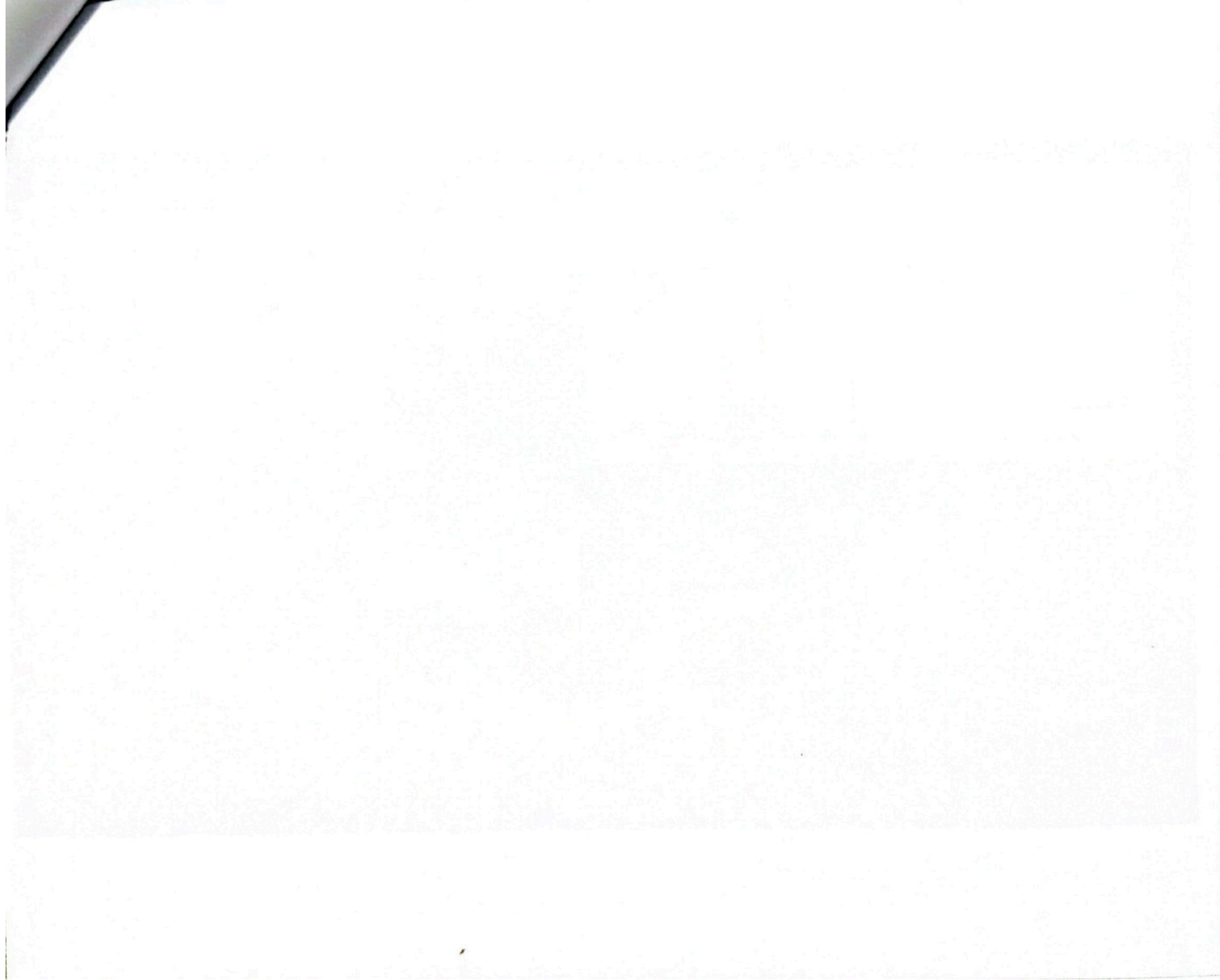

TIETON TERRACE PARK – 0.42 Acres

Tieton Terrace Park is a small pocket park located at the intersection of South 26th Avenue and West Walnut Street. Amenities are limited to picnic tables, a park bench and a swing set.

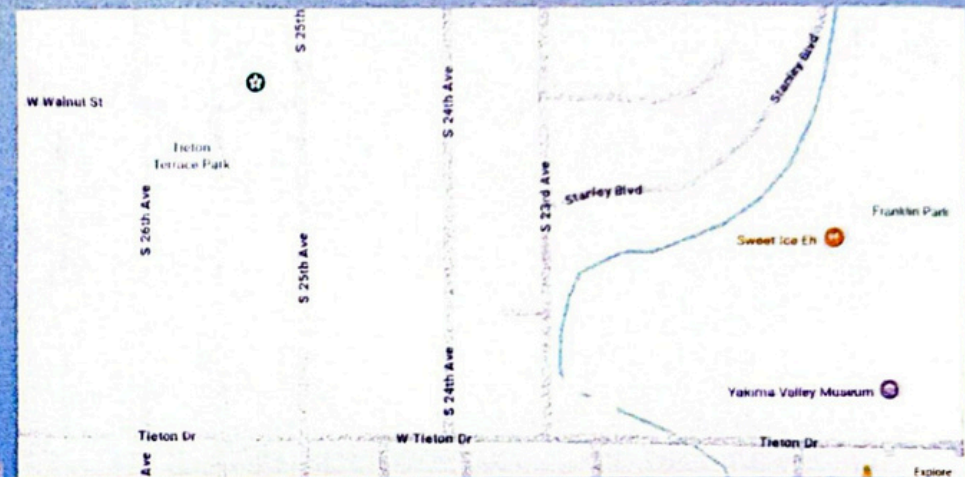

Maintenance/Operation Expense: \$8,000

Revenue: NA

Capital Improvements: NA

Planned Capital Improvements:

- Sign
- Small Playground
- Small Picnic Shelter
- Replace Fence



Rosalma Garden Club Park – 0.31 Acres

The Rosalma Garden Club Park is located at the southeast corner of the Tieton Drive and South 16th Avenue intersection. This small triangular shaped park provides green space, mature plantings and stone benches.

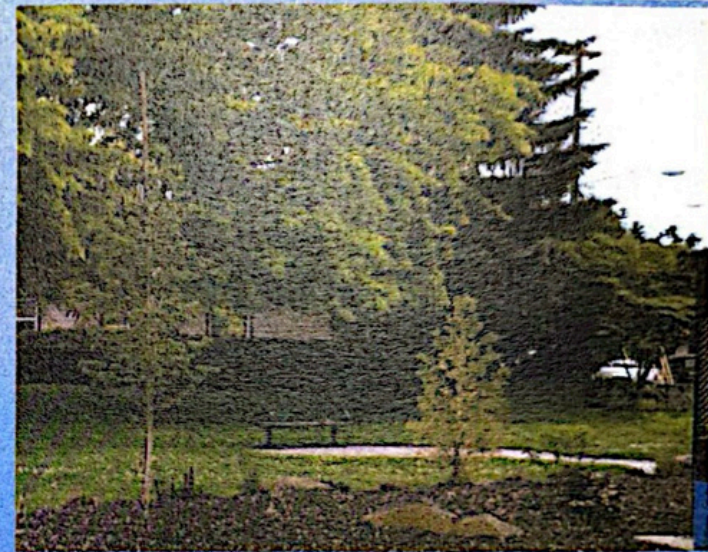

Maintenance/Operation Expense: \$5,700

Revenue: NA

Capital Improvements:

2016- \$20 000 Park Renovation - Donation

Planned Capital Improvements:

- Sign

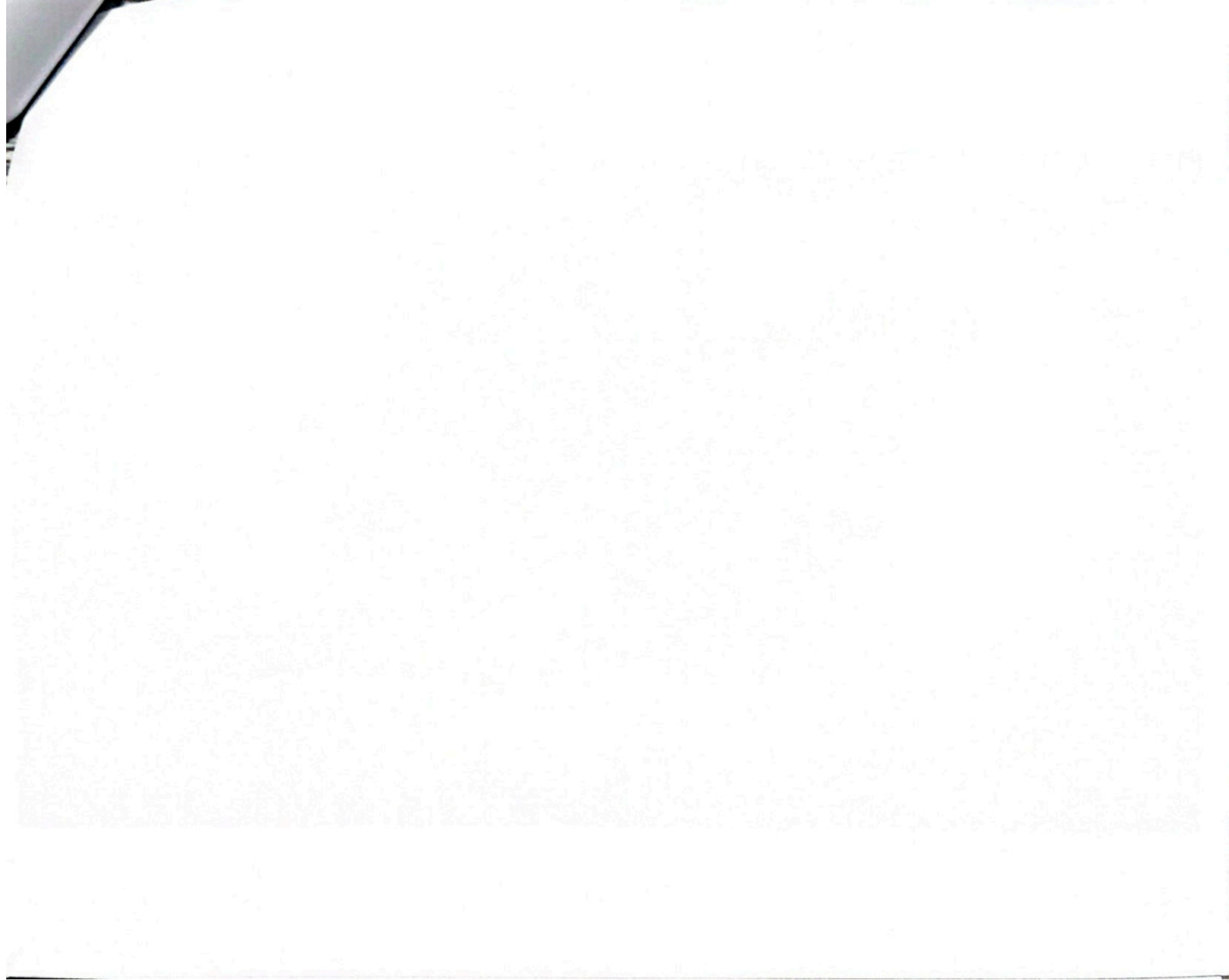

PORTIA PARK – 0.52 Acres

Portia Park is a small triangular pocket park west of downtown at Yakima and 12th Avenues. Because of its location, Portia Park provides visual interest and green space to the neighborhood. The park contains mature shade trees and a few picnic tables.



Maintenance/Operation Expense: \$3,600

Revenue: NA

Capital Improvements: NA

Planned Capital Improvements:

- Small Picnic Shelter



South 6th Avenue Parkway – 0.17 Acres

A block-long median parkway with trees, South 6th Avenue Parkway separates 6th Avenue's northbound and southbound traffic in between Tieton Drive and Division Street



Maintenance/Operation Expense: \$2,800

Revenue: NA

Capital Improvements: NA

Planned Capital Improvements:

- Replace Broken Sidewalk Sections

